

Andalusia Design
Specification Guide

Monet

Perforate™ Parametric
Wall and Ceiling System

ANDALUSIA DESIGN

Andalusia Design is a manufacturer of specialty ceiling, wall and space divider solutions. We combine the power of parametric design with best-in-class digital fabrication capabilities to deliver high-design architectural systems with unparalleled speed and efficiency. We have a large showroom and vertically-integrated manufacturing facility in Austin, TX, USA.

PERFORATE

Andalusia Design's Perforate metal wall and ceiling system is a highly-configurable platform that gives designers the freedom to create unique perforated patterns for their client's spaces.

Driven by Andalusia's parametric design engine and in-house digital fabrication, Perforate is ideal for brand-forward, high-traffic areas for commercial and hospitality applications. Designs and hole patterns can be specified and optimized for both aesthetic and budget.

PERFORATE OPTIONS

Perforate is offered in standard configurable and customizable pattern styles. Key Perforate system attributes:

- Available in steel and aluminum, in a variety of standard and custom powder coated finishes
- Standard and custom fiber-laser cut patterns can be fit to your exacting wall and ceiling dimensions
- Option to integrate backlighting with acrylic diffuser to create a dynamic visual effect
- Option to add a composite backing for sound absorption
- Fits into standard grid configurations or can be customized

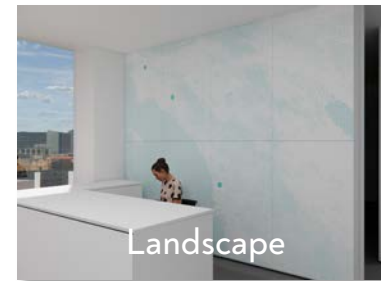



With Monet, translate images of awesome, scenic views – like oceans, mountains, deserts and forests – into impressionistic perforated patterns.

PERFORATE – HOW DOES MONET WORK?

Andalusia's parametric software gives users the ability to not only transpose an image onto their Perforate surface, but also fine-tune design variables to meet aesthetic and budgetary requirements.

- A. Choose an image. Preferably an image with good resolution and high contrast.
- B. Andalusia's parametric image mapping tool takes a grayscale image of the grid and turns it into a hole pattern that accurately reflects the image.

C. Users are able modify the variables to optimize for design taste, functional requirements and budgetary constraints, including:

- Resolution (density of holes)
- Contrast (size of holes)
- Positive or Negative image
- Hole type (circle, square, triangle, etc.) to optimize visual interest
- Backlighting, acoustic backing or open
- Material and finish

Black powder coat RGB backlit tree image with circle perforations

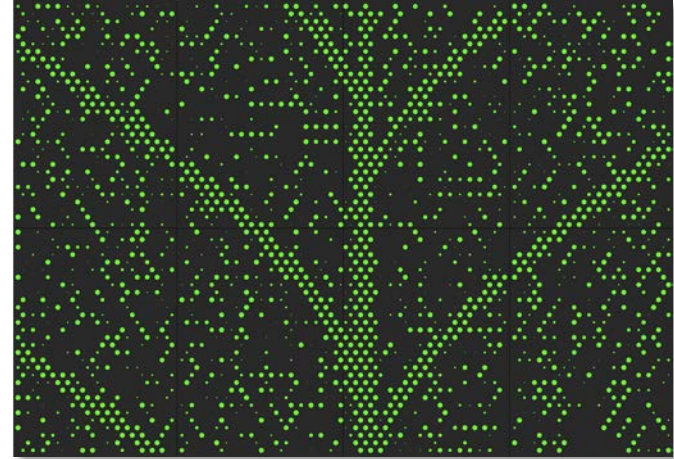

Gray powder coat backlit tree image with triangular perforations

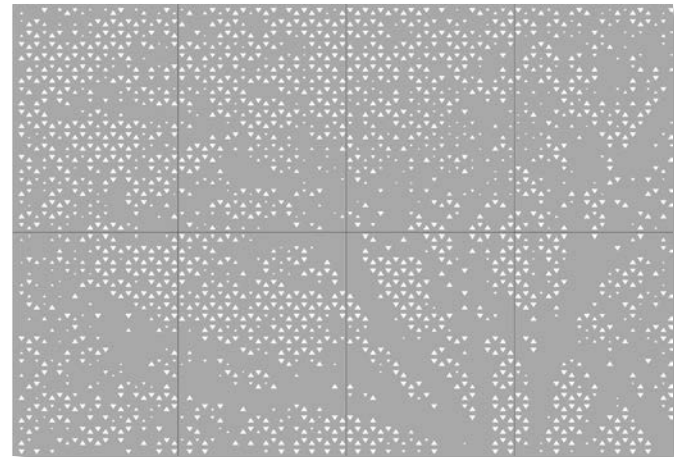

DESIGN STEP 1: CHOOSE YOUR IMAGE

Andalusia can take images of nearly any scale, with a preference towards high resolution, high contrast imagery. Simple images are generally easier to transpose to a perforated pattern. Andalusia will help optimize and process your image for the optimum perforated pattern.



Realistic tree image



Simple tree image (preferred for image mapping)

DESIGN STEP 2: CHOOSE YOUR APPLICATION – CEILING, WALL OR WALL-TO-CEILING

Perforate can be used for wall, ceiling and wall-to-ceiling applications. Wall and ceiling materials and installation differ slightly, but both work with standard installation components and are easy to install.

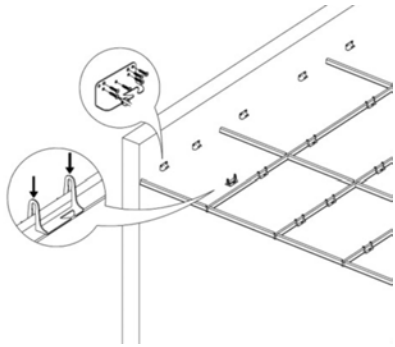

Andalusia saddle clips are added to standard ceiling grid

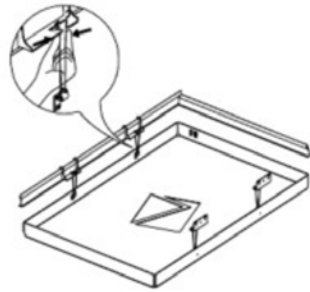

Torsion spring mechanism locks ceiling panels in place

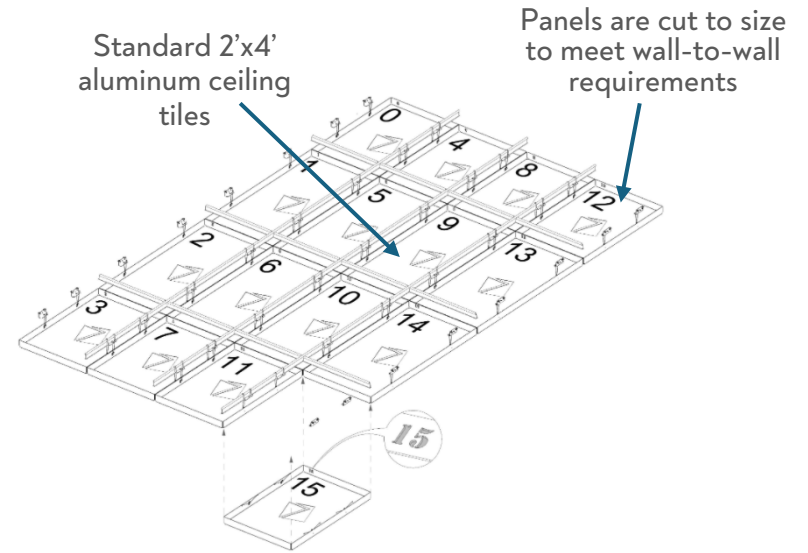

Standard 2'x4' aluminum ceiling tiles

Panels are cut to size to meet wall-to-wall requirements



Wall-mounted system uses simple Drop and Lock mechanism



All tiles are numbered with the associated final schematic to ensure ease-of-installation

DESIGN STEP 3: DETERMINE YOUR ARRAY SIZE

Determine the dimensions of your wall and/or ceiling plane. Andalusia will typically work with standard 2'x4' grid tile sizes for ceilings and 4'x4' tiles for walls, but can accommodate different sizes, including near edge conditions.

Measure the overall dimension of your array –
X and Y dimensions.

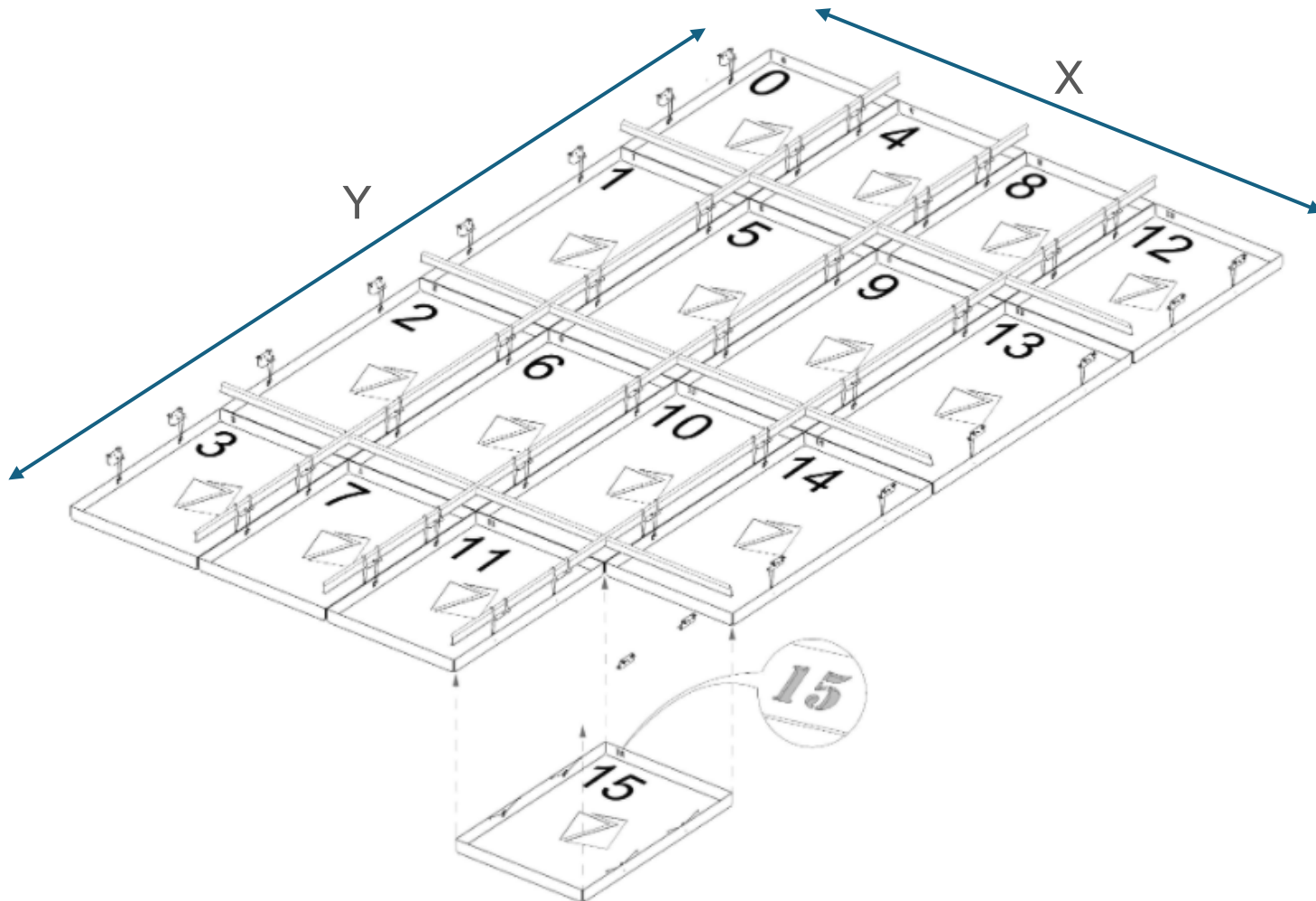

DESIGN STEP 4: DETERMINE YOUR ASPECT RATIO

The size of your Monet array will impact your perforated system's resolution and aspect ratio.

Original image



Determine if you want to LOCK the aspect ratio of the original image or if you want to FILL the space with perforations

Contact Andalusia to ensure the perfect fit!

Note: The larger your wall or ceiling system, you can achieve more resolution of your full image with fewer perforations per area

FILL - Fill the wall or ceiling plane



LOCK - Lock the aspect ratio of the original image



DESIGN STEP 5: CHOOSE AN IMAGE RESOLUTION

Your Perforate image resolution (or perforations per inch) can impact your aesthetic and price point. The fewer holes per array, the less time it spends on our fiber laser, thus the less expensive it is. But you sacrifice resolution. Below are examples of systems going from a more abstract, lower resolution (1) to a more literal, higher resolution (3).



DESIGN STEP 6: PICK A HOLE TYPE

Using Andalusia's advanced laser cutting techniques, you're not limited to circles for your hole patterning – you can choose from circles, squares, diamonds, triangles... or connect with us to make a cool cut just for you!

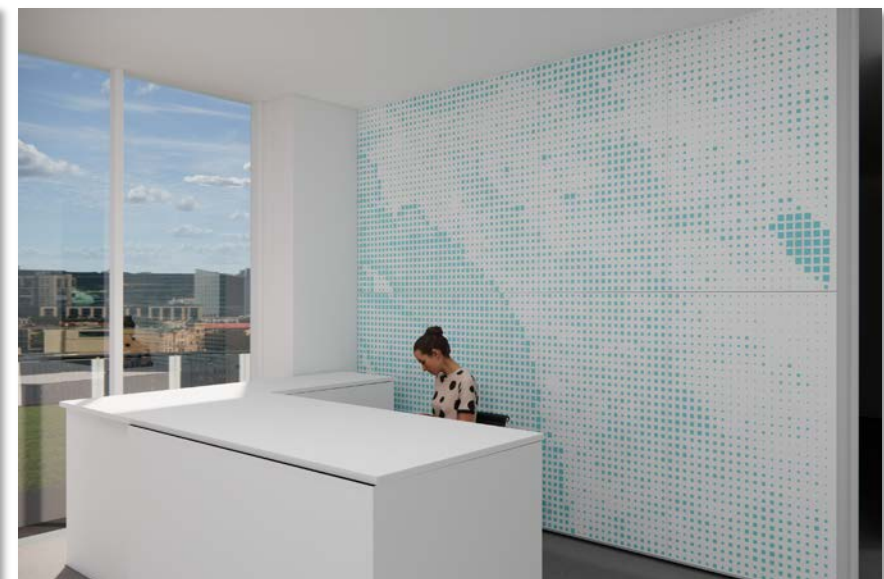

DESIGN STEP 7: SELECT YOUR COLOR / FINISH

Choose from a variety of standard color / finish options, or work with Andalusia to create something unique!

Standard Color Palette

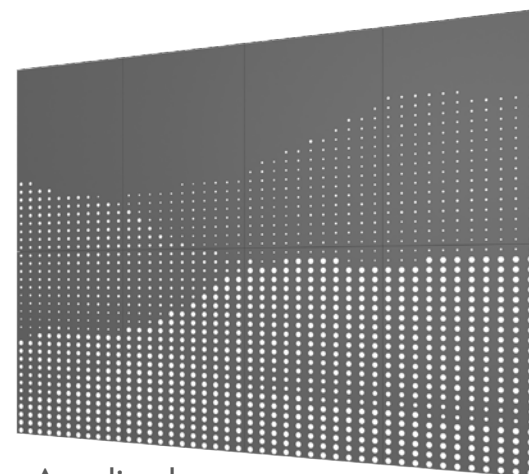

Anodized Silver

Premium Color Palette

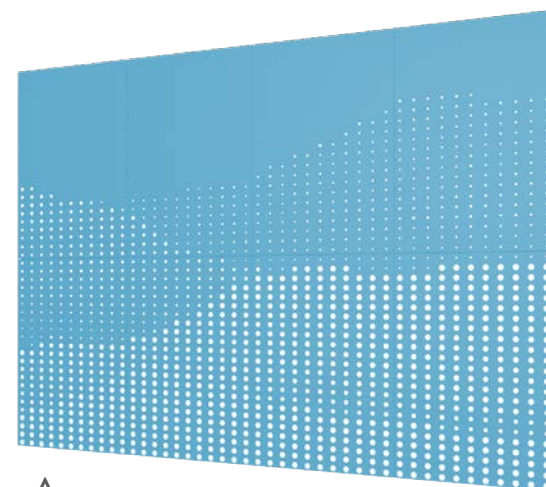

Azure Horizon

DESIGN STEP 8a: OPTIONAL BACKLIGHTING

Perforate can be enhanced with backlighting to make your Monet 'pop'. Backlighting the system adds additional cost and complexity – below are considerations when designing.



- A. Andalusia does not offer its own backlighting solution, but has recommended partners in every region
- B. When specifying backlighting, Andalusia offers a standard acrylic diffuser that is custom fit into each Perforate panel
- C. For most backlighting applications, a sheet LED array with 6" diode spacing is ideal. The LED array must be mounted at least 3" from the panel diffuser.
- D. The more room there is behind the panels, the more opportunities there are for cost-effective lighting solutions. Contact Andalusia to learn more.
- E. Andalusia can work with you to optimize hole sizes and patterns to help achieve any functional lighting requirements you may have

DESIGN STEP 8b: OPTIONAL FELT BACKER

If the Monet is in a well-lit area of a space and you're looking to add a pop of color and/or functional acoustic performance, Perforate can be supplied with a standard composite backer. Contact Andalusia for more information on standard and custom options, along with functional specifications.



CUSTOMIZATION OPPORTUNITIES



Add a replaceable magnetic center insert that can be used to highlight a brand; light it independently with RGB!



Circles, squares, triangles and diamonds are great... but add your own unique spin with custom hole cutouts!

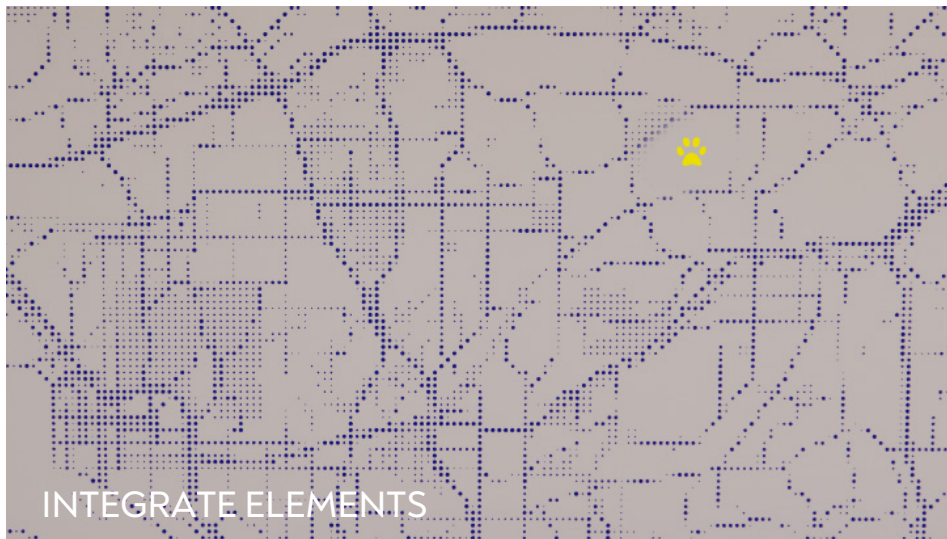

Downlights, sprinkler heads, other functional elements or branded content can be added without losing design intent.



Contact Andalusia for the perfect wall-to-wall fit for your Perforate design.

SERVICES AND DOCUMENTATION

Below is a list of typical design and technical services, along with the documentation you can expect to receive when designing, specifying, procuring and installing an Andalusia Perforate system.

DESIGN PHASES

Services and Outputs:

- Collaborative and iterative design development, starting as early as concept design
- 3D parametric model development; ability to collaborate in Rhino and Revit or output to any standard CAD platform
- Renderings in Enscape, V-Ray
- Real-time pricing information during design iterations and design-for-budget / VE support
- Thorough product design proposals
- Physical material samples and color swatches
- Custom samples to demonstrate form / function of unique designs
- Assistance with client-facing presentations, as desired

POST-DESIGN / SPEC SUPPORT

Services and Outputs (in addition to Design outputs):

- Technical drawings – elevations, sections, details
- CSI MasterSpec document
- Comprehensive dimensions, thickness, weight information
- Final digital 3D model
- Final contractor net pricing
- Performance data, including ASTM E84 fire ratings, structural data, acoustic analysis, along with necessary supporting test data
- Sustainability certifications, EPD, HPD, Declare
- Detailed step-by-step installation instructions
- Maintenance and warranty information
- Reference part numbers and details
- Andalusia contact information

ONE-PAGE PERFORATE DESIGN CHECKLIST

Let's get started! Fill out the attached form, along with a full pattern in CAD or other medium, and we'll get to work!

APPLICATION

- W – Wall mount
- C – Ceiling
- WC – Wall-to-ceiling

IMAGE

- Object

- Attached image
- Notes (zoom level, etc.)

- Resolution: Hi, Med, Lo

ARRAY SIZE

- X Dimension

- Y Dimension

POWDER COAT FINISH

- Signal White
- Traffic White
- Pure White
- Champagne
- Quartz Gray
- Anodized Silver
- Black
- Sea Blue*
- Azure Horizon*
- Copper Ember*
- Vintage*
- Scarlett Shine*
- Tourmaline*
- Ancient Ore*
- RAL _____

* Denotes Premium Finish

HOLE TYPE

- Circle
- Triangle
- Square
- Diamond
- Other

BACKING OPTION

- Backlighting with Acrylic diffuser
- Notes:

- Composite backing
- Color: _____
- Notes:

CUSTOMIZATION INTEREST

- Custom Insert

- Wall-to-wall
- Integrated components (HVAC, sprinklers, etc.)

OTHER QUESTIONS

Project stage _____

Approximate SF _____

Approximate budget / SF _____

Modeling software _____

Other unique variables

Need Assistance on
your next Project?

Contact us at
hello@andalusia.design